



Acme Sanitary Ware Co Ltd

Acme Building, 22-28 Nanking Street, Kowloon, Hong Kong
Tel: 2388 7171 Fax: 2710 8012
E-mail: acme@acmesanitary.com.hk
Website: www.acmesanitaryware.com.hk



Pure Freude
an Wasser

| | | | | | | |
|----------|--|------|--|-----|-----------|--|
| PROJECT | | REF | | REV | ITEM CODE | |
| LOCATION | | DATE | | | PAGE | |

SANITARY WARE SPECIFICATION SHEET

| | |
|-------------------|---|
| Item Descriptions | GROHE (Germany) "Plus" Single-lever basin mixer 1/2" S-Size with pop-up waste set |
| Dimensions | L111 x W51 x H208 mm |
| Model | 23870003 |
| Finish | Chrome Plated |
| Country of origin | Germany |
| Manufacturer | GROHE Limited |
| Supplier | Acme Sanitary Ware Co. Ltd Mr. Eric Wong/ Mr. Don Yuen |
| Contact Tel/Fax | (852) 2388-7171 / (852) 2710-8012 |
| E-mail | acme@acmesanitary.com.hk |
| Website | www.acmesanitary.com.hk |

Illustration/ Drawing

"Plus"
Single-lever basin mixer 1/2" S-Size

- monobloc installation
- metal lever
- **GROHE SilkMove ES** 28 mm ceramic cartridge with energy saving function via cold start
- with temperature limiter
- **GROHE StarLight** chrome finish
- **GROHE EcoJoy** SpeedClean mousseur 5.7 l/min
- **GROHE AquaGuide** adjustable mousseur
- **GROHE QuickFix Plus** installation system
- pop-up waste set 1 1/4"
- flexible connection hoses

Colour options:

- 003 | StarLight Chrome
- DC3 | SuperSteel
- AL3 | Brushed Hard Graphite

Note:

* All information of the above is for the reference only. No prior notice is made if any changes.



Acme Sanitary Ware Co Ltd

Acme Building, 22-28 Nanking Street, Kowloon, Hong Kong
Tel: 2388 7171 Fax: 2710 8012
E-mail: acme@acmesanitary.com.hk
Website: www.acmesanitaryware.com.hk



Pure Freude
an Wasser

| | | | | | | |
|----------|--|------|--|-----|-----------|--|
| PROJECT | | REF | | REV | ITEM CODE | |
| LOCATION | | DATE | | | PAGE | |

SANITARY WARE SPECIFICATION SHEET

GROHE PLUS

ACCURACY THAT GOES BEYOND DESIGN

Imagine a bathroom that offers not just sleek, cutting-edge, bold design design, but also confidence and control. Where you can tell water temperature at a glance and switch water flow with just a swipe of your hand. A room where nothing is left to chance, where form delivers function in a sleek, tactile package. With the new GROHE Plus you can make it a reality.

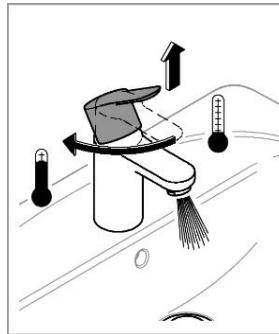

This innovative range puts control and convenience in your hands, delivering accurate temperature information at a glance. The GROHE Plus range includes some faucets with a temperature display, so you know the water will always be just the right temperature. GROHE Plus also offers a new level of ergonomic comfort and practical function too, presented in a silhouette of architectural strength and elegance, with surfaces so sleek they invite interaction.

Pop-up waste for easy operation

Elegant and easy to operate: close the pop-up waste by pulling the rod at the back of the tap and push down to open it again.

SPARE PARTS

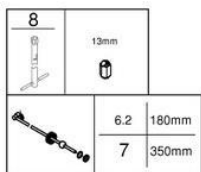
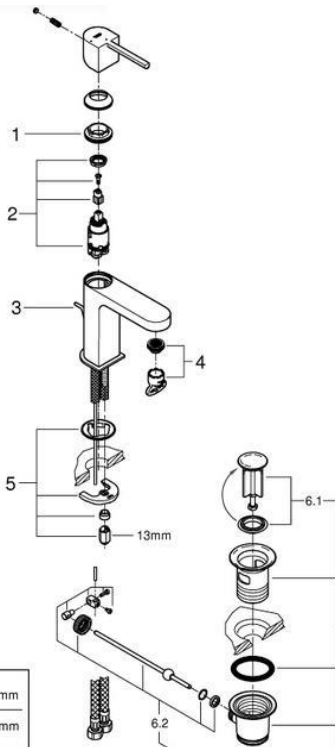

GROHE EcoJoy with water-saving function for reduced consumption

GROHE EcoJoy reduces water consumption by up to 50% without compromising on performance. Whenever you turn on your tap, you will enjoy a full jet of water while saving money nonetheless.



GROHE QuickFix Plus – quick and easy installation in a few simple steps

Save time on the installation of your tap with GROHE QuickFix Plus. Consisting of fewer parts, our new system makes the installation process quicker and easier than ever.

| Pos.-nr. | Prod. description | Order-nr. |
|----------|---------------------------|-----------|
| 1 | Fitting ring | 07419000 |
| 2 | Cartridge | 46580000 |
| 3 | Pop-up rod | 46739000 |
| 4 | flow control adjust | 48449000 |
| 5 | Shank fastening assembly | 46645000 |
| 6 | Waste set 1 1/4" | 28910000 |
| 6.1 | Plug for waste set 1 1/4" | 07182000 |
| 6.2 | Eccentric rod | 07052000 |
| 7 | Ball rod | 07341000* |
| 8 | Mounting wrench | 19017000* |

* Optional accessories



Note:

* All information of the above is for the reference only. No prior notice is made if any changes.